

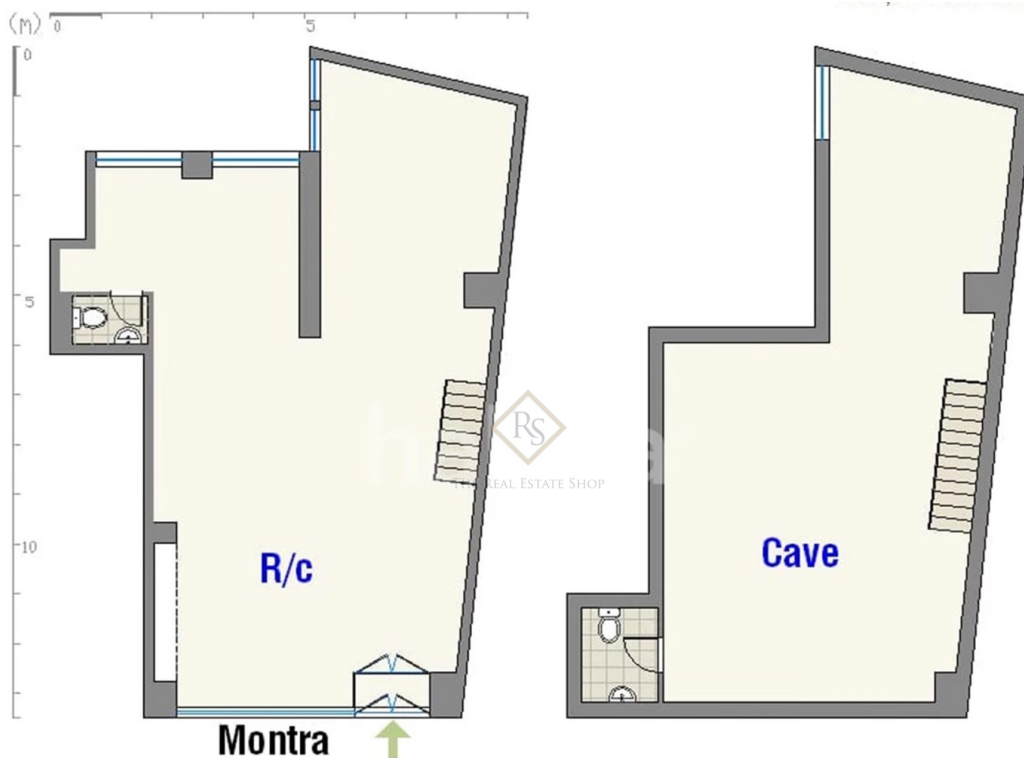

Santo António - Commercial property



A.bruta coberta = 91 + 77



Area (m²)

3 000 € / Month

(EUR €)

Commercial Space | Braamcamp | Central Location

Commercial space located on Rua Braamcamp, between Largo do Rato and Marquês de Pombal. With a gross area of 168m² spread over two floors, the store stands out for its large window, ensuring visibility and natural light.

In the past used as a spa and currently adapted for office and storage, the property has the potential to adapt to various types of businesses (it does not have smoke extraction).

The privileged location in the center of Lisbon ensures easy access and a large flow of people, making this space a strategic choice for companies looking to stand out.



Sofia Tonim

Founder and CEO

+351969275559 ² · 211649165 ¹

st@therealestateshop.pt

T +351 969275559 ² · T +351 910481393 ² · E officemanager@therealestateshop.pt

Travessa Fábrica das Sedas 28A
AMI 14313

¹ (Call to national fixed network) | ² (Call to national mobile network)



24-TRES254

Reference

Scan the QR code to view the property



Property Features



Sofia Tonim

Founder and CEO

+351 969275559 ² · 211649165 ¹

st@therealestateshop.pt

T +351 969275559 ² · T +351 910481393 ² · E officemanager@therealestateshop.pt

Travessa Fábrica das Sedas 28A

AMI 14313

¹ (Call to national fixed network) | ² (Call to national mobile network)